

# HOMER TOWNSHIP SECTION 13 R13 TWP 7 MORGAN COUNTY, OH

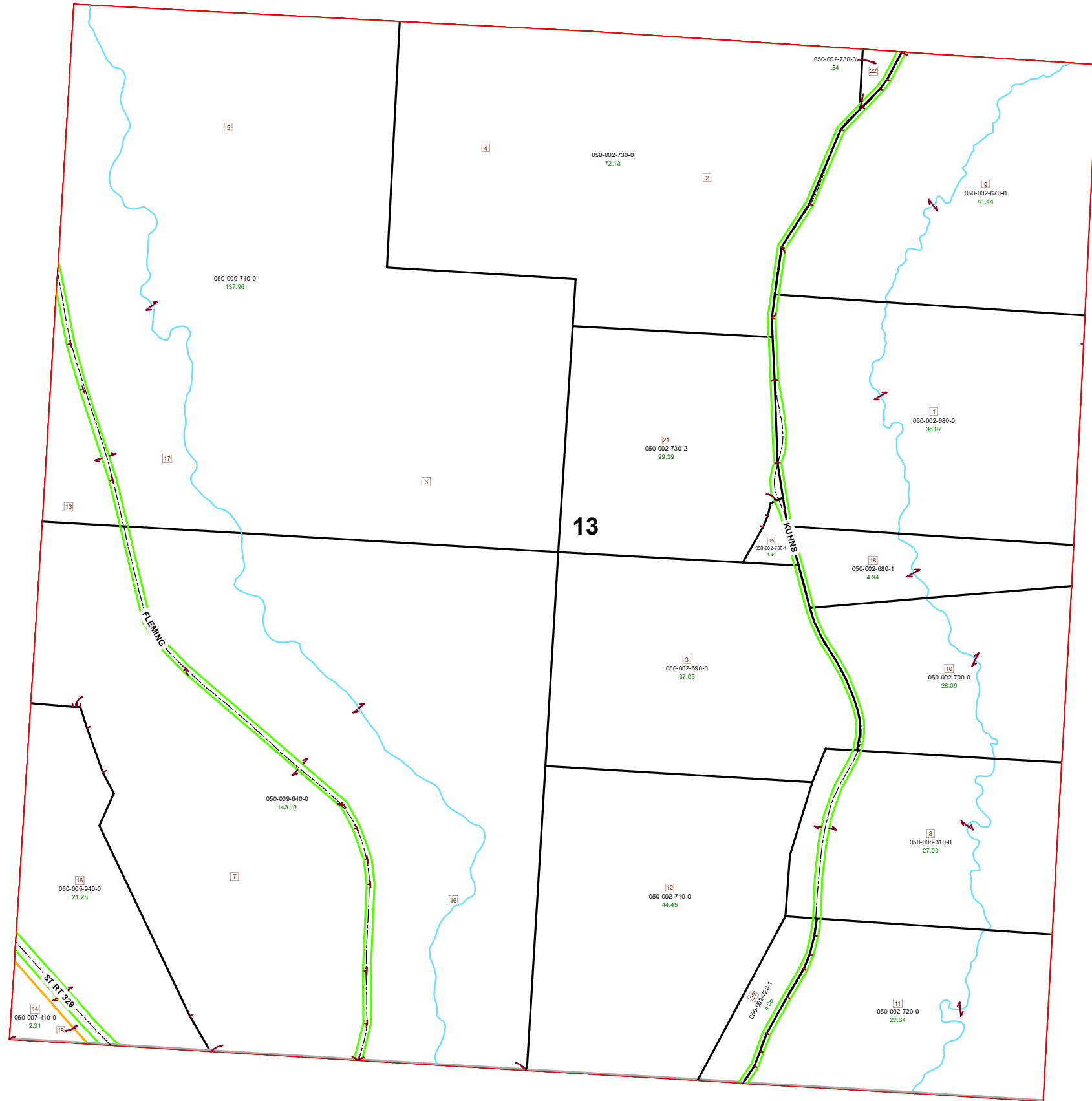

PIN	VOL	PAGE	Owner	LegalDescr	Acres
050-008-310-0	OR205	298	DOWLING WILLIAM A & LAUREN N	R13 T07 S13 SD 8 S	27
050-002-680-0	OR11	729	EVERETT HERBERT E & EVELYN KAY	R13 T07 S13 SD 1 S	36.07
050-002-670-0	OR11	729	EVERETT HERBERT E & EVELYN KAY	R13 T07 S13 SD 9 S	41.44
050-002-730-2	OR133	215	MCGEE KEVIN R & MARCIA S	R13 T07 S13 SD 21	29.395
050-002-720-1	OR86	741	MCGEE KEVIN R ETAL	R13 T07 S13 SD 20	4.06
050-002-710-0	OR86	741	MCGEE KEVIN R ETAL	R13 T07 S13 SD 12	44.45
050-002-690-0	OR86	741	MCGEE KEVIN R ETAL	R13 T07 S13 SD 3 S	37.05
050-002-730-1	OR133	215	MCGEE KEVIN R ETAL	R13 T07 S13 SD 19	1.24
050-007-110-0	OR65	1	MCLAUGHLIN SEAN T & SHANTELE L	R13 T07 S13 SD 14	2.31
050-002-700-0	OR224	3442	MINGUS RALPH PAUL & ANN E TRUSTEES	R13 T07 S13 SD 10	28.06
050-002-680-1	OR224	3442	MINGUS RALPH PAUL & ANN E TRUSTEES	R13 T07 S13 SD 18	4.941
050-002-720-0	OR210	3143	MUNRO BRAD & RACHEAL	R13 T07 S13 SD 11	27.646
050-002-730-0	OR39	533	RIGGS JOHN F & KATHY E	R13 T07 S13 SD 2-4	72.137
050-002-730-3	OR221	2951	RINI WILLIAM T & LUDOVINA CO TRUSTEES	R13 T07 S13 SD 22	0.841
050-009-640-0	OR220	1362	WAGNER KEVIN S & KELLEEN	R13 T07 S13 SD 6 E	143.096
050-009-710-0	OR220	1362	WAGNER KEVIN S & KELLEEN	R13 T07 S13 SD 5 E	137.961
050-005-940-0	OR228	3340	WILSON MATTHEW A & HEDIA	R13 T07 S13 SD 15	21.28

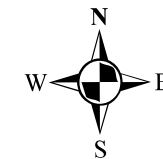

Boundaries	
-----	Hidden
-----	Roads
-----	County
-----	Parcel
-----	Lot
-----	Township
-----	Section
-----	Parcels
-----	ROW
-----	Hydro

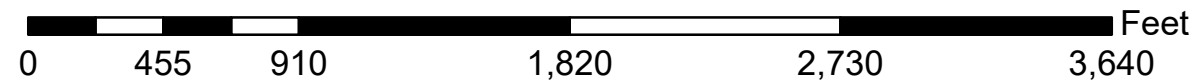

Disclaimer: The information that these maps contains is for reference purposes only. Please bring any errors to the attention of the Engineer's Office staff.  
Thank you